



Back Cover



Front Cover

an easy feeling

When it comes to alarm systems, businesses all agree: they want a system that's reliable, easy to see, easy to understand and most of all, one that's easy to use. Thanks to DMP's new Thinline™ Series keypads, choosing a system has never been easier!

The stylish new Thinline is the perfect blend of technology and aesthetic sensibility. But don't let its good looks fool you—its beauty is more than just skin deep.

When an alarm has been activated Thinline sounds the alarm, changes color, and spells out details on its large, easy-to-read display. With features such as this, the line between functionality and superior design has never been so thin.



large, easy-to-read display clearly spells out the status of your system.

customizable name display can be programmed with up to 16 characters of custom text.

quick, two-button panic keys

enable you to easily send police, emergency or fire signals

to the monitoring center, all the while protecting against accidental or false alarm calls.

user-friendly controls allow you to easily adjust keypad brightness and volume.

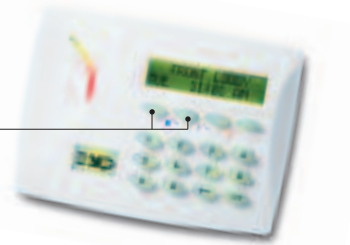

secure and simple

Thinline™ will change your view of security with its sleek and simple design.

large, easy-to-see LED indicator shows the status of your alarm, enabling you to instantly recognize whether your system is powered, and fully or partially armed.

the sleek, stylish design of DMP's new

Thinline lends elegance to your business while making viewing easy on the eyes. LCD displays are available in a brilliant green (Thinline) or cool blue (Aqualite™).

But perhaps the most desirable feature is not its good looks, or its functionality, but its simplicity of use.

easy-to-use menus guide users through an intuitive scrolling system, quickly and efficiently presenting menu options. Easily choose the desired option using the command key, or return one step at a time with the back arrow key. The perfect

menu for a multi-user environment.

arming made simple! By scrolling through the display, users can easily bypass zones, check system status, display events, reset sensors or turn outputs on and off with only a few key presses.

remembering access codes for system disarming can be a thing of the past with Thinline's optional proximity disarming function—simply wave a proximity token or card in front of the keypad and the system is quickly disarmed!



large, 32-character LCD display with 16-character customizable name display

displays time of day, armed zones and armed areas

sleek, low-profile design complements architectural aesthetics

built and tested in the USA to assure quality and reliability

red light visually alerts user that system is armed

system can remain armed after an alarm is silenced

keypad lighting illuminates red during an alarm so you can instantly see as well as hear the alert

distinct sound patterns indicate type of alarm

simple codeless operation with proximity token

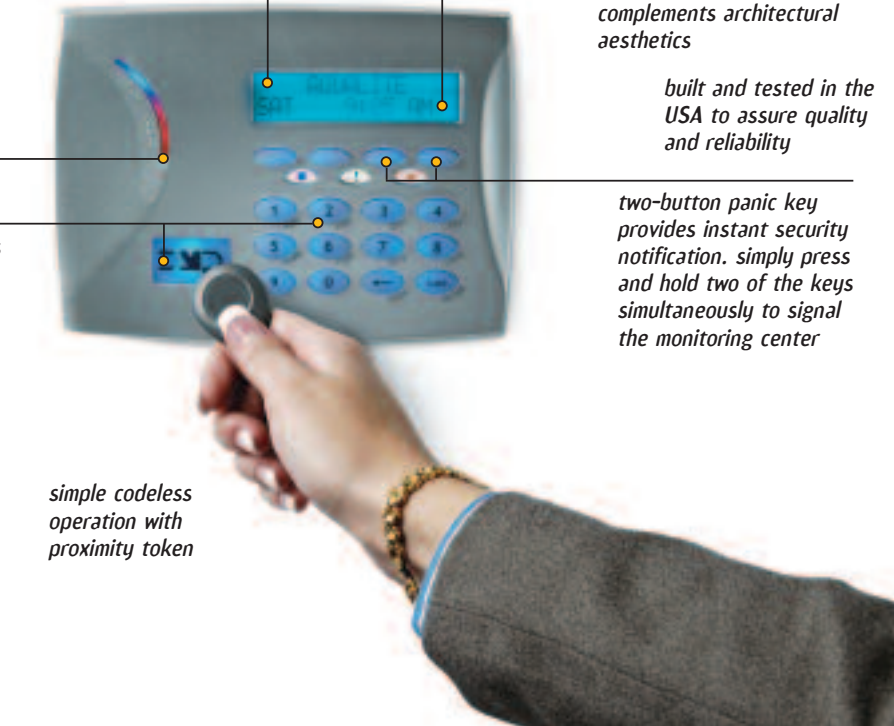

Thinline™ Series
green backlighting, available in white, ivory, and black



Aqualite™ Series
blue backlighting, available in white, platinum and black



security with style Thinline's sculpted new look adds elegance to its impressive list of features, making it a visual asset to your workplace. And the cool blue Aqualite option delivers the same reliable security control as the standard Thinline keypad—in a fresh new light.

For more information on Thinline and Aqualite keypads or other trusted DMP products, contact your alarm specialist—or 800.641.4282 for the nearest authorized DMP dealer.

LT-0873

